

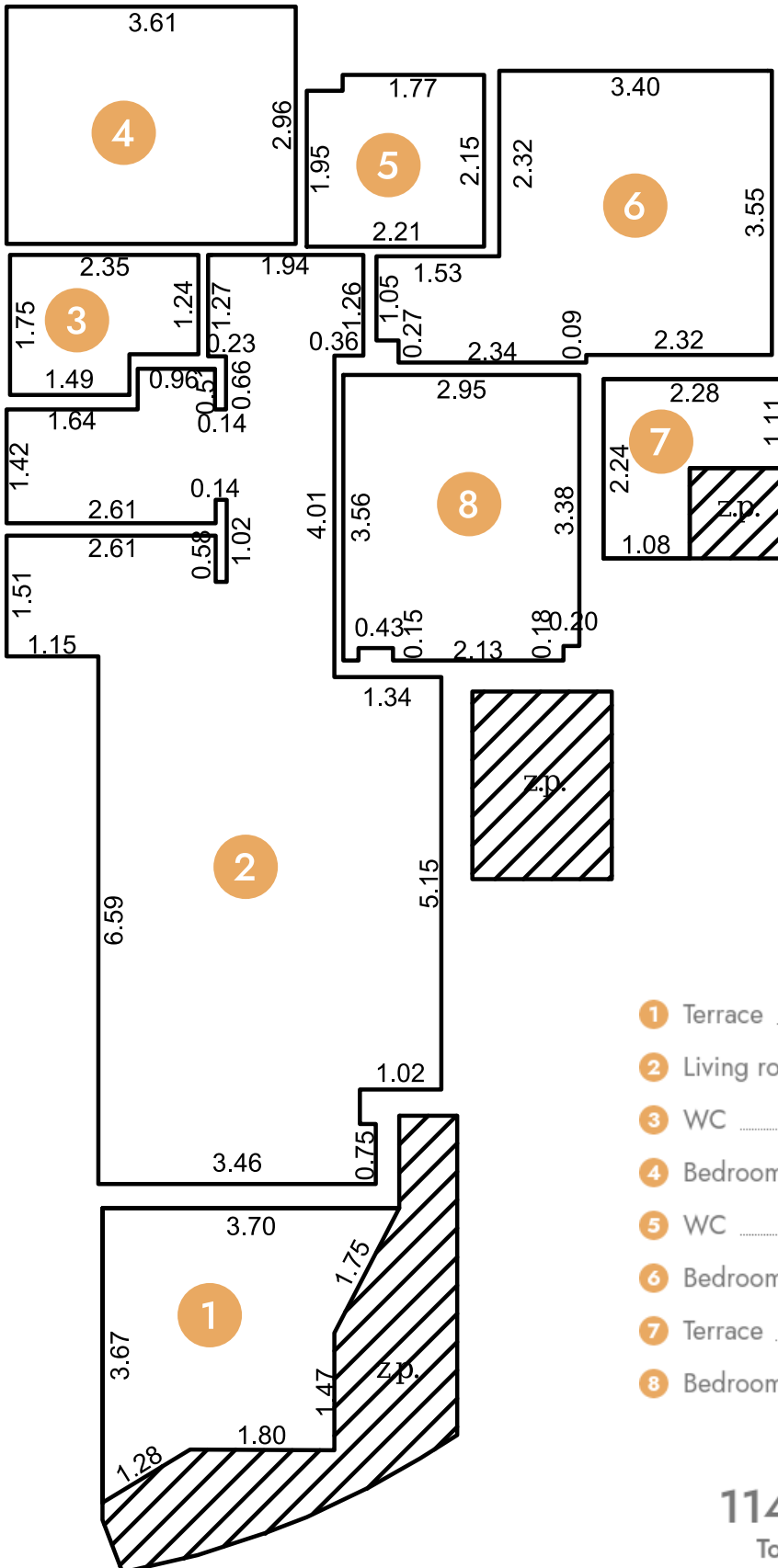

Montesa Hill - PD40





1	Terrace	9.71m ²
2	Living room	42.70m ²
3	WC	3.67m ²
4	Bedroom	10.69m ²
5	WC	4.66m ²
6	Bedroom	14.11m ²
7	Terrace	3.74m ²
8	Bedroom	10.40m ²

114m²
Total

14m²
Greening

-  Sea view
-  Floor heating

-  Air conditioning
-  Fiber optics network